



TOWN OF TEWKSBURY, MASSACHUSETTS
Sewer Department
RESIDENTIAL OR COMMERCIAL BUILDING
Sewer Application

001191

Marked Date 4-30-12
PAID
AUG 18 1992
TEWKSBURY D.P.W.

To the Town of Tewksbury, Massachusetts:

The undersigned, being the William & Ellen Donohue of the property at 239 Fiske St.
(Owner/Owner's Agent)
(Number and Street), does hereby request to install and connect a building sewer to serve the residence at said location.
(Residence, building, etc.)

1. The following indicated fixtures will be connected to the proposed building sewer:

Number	Fixtures	Number	Fixtures
<u>1</u>	Kitchen sinks	<u>1</u>	Water closets
<u>1</u>	Lavatories	<u>1</u>	Bath tubs
<u>0</u>	Laundry tubs	<u>0</u>	Showers
<u>0</u>	Urinals	<u>0</u>	Garbage disposals

Specify other fixtures _____.

2. The number of persons who will use the above fixtures is 4.

3. The name and address of the person or firm who will perform the proposed work is:

Weitz Construction
148 Deering Drive
Tewksbury, MA

4. Plans and specifications for the proposed building sewer are attached hereto as exhibit "A".

5. Notification of Water Department to layout water service.

In consideration for granting this permit, the undersigned agrees:

- To accept and abide by all provisions of the Rules and Regulations governing the use of sewers of the Town of Tewksbury, and of all other pertinent rules and regulations that may be adopted in the future.
- To pay all the cost of said building sewer and its connection to the public sewer in said street, including all labor and materials or other expense incurred necessary for the proper construction of said building sewer as determined by the Town of Tewksbury.
- To maintain the building sewer at no expense to the Town of Tewksbury.
- For himself, his heirs, devisees and assigns, that the Town of Tewksbury shall have access at all reasonable hours, to said premises, to see that all laws, by-laws, ordinances, rules and regulations relating to the sewer are complied with.
- To notify the Town of Tewksbury when the building sewer is ready for inspection and connection to the public sewer, but before any portion of the work is covered.
- That construction of the sewer connection will be completed within sixty (60) days of issuance of this permit.

Date: August 18, 1992

Signed: Ellen Donohue
(Applicant)

APPROVED: [Signature]
(Plumbing Inspector)

DATE: 9/23/92

MAP _____ LOT _____

DATE: Marked Date 9-30-92
Wm J. Wilfong Jr. Foreman
Water Department (LC)

DATE TO BE INSTALLED: _____

FINAL APPROVAL: WRB 9/23/93
(Public Works Superintendent)

DATE: _____

Sewer Permit No. 001191

Dig Safe No. 9235-0371

Drainlayer: _____

Repair) A Drain at No. _____

Connect) _____

Inspector Thomas Girello

Work Started 10/5/92 Work Finished 10/5/92

I hereby certify that the service connection for the property appearing on the first page of this application was built in conformance with the Rules and Regulations governing the use of the Town of Tewksbury and is accurately depicted on the attached as built drawing.

Date: 1/5/93 Signed: [Signature]
(Drain Layer)

239
FISKE ST.



OCT 5, 1992
WEITZ CONST.

RECORD OF SEWER SERVICE

40/20

House No. 239

Street Fiske

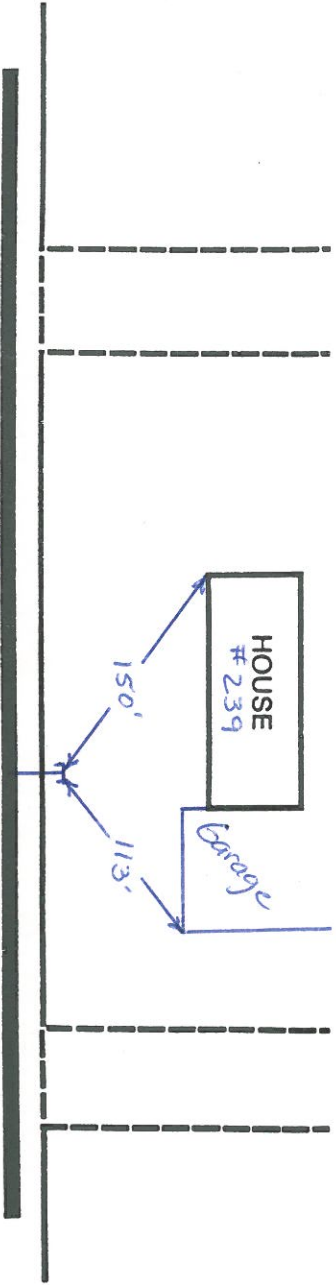

Fiske Street

Service size & mat'l' 6" PVC 15'

Wye distance from downstream manhole 98'

Height of chimney at main _____

Invert elev. @ property line _____

or

Depth of invert from ground surface _____

Lateral from main installed by Albanese Bros. Date: 10-6-86

House connection installed by _____ Date: _____