

INSET 'A'
SCALE: 1" = 20'

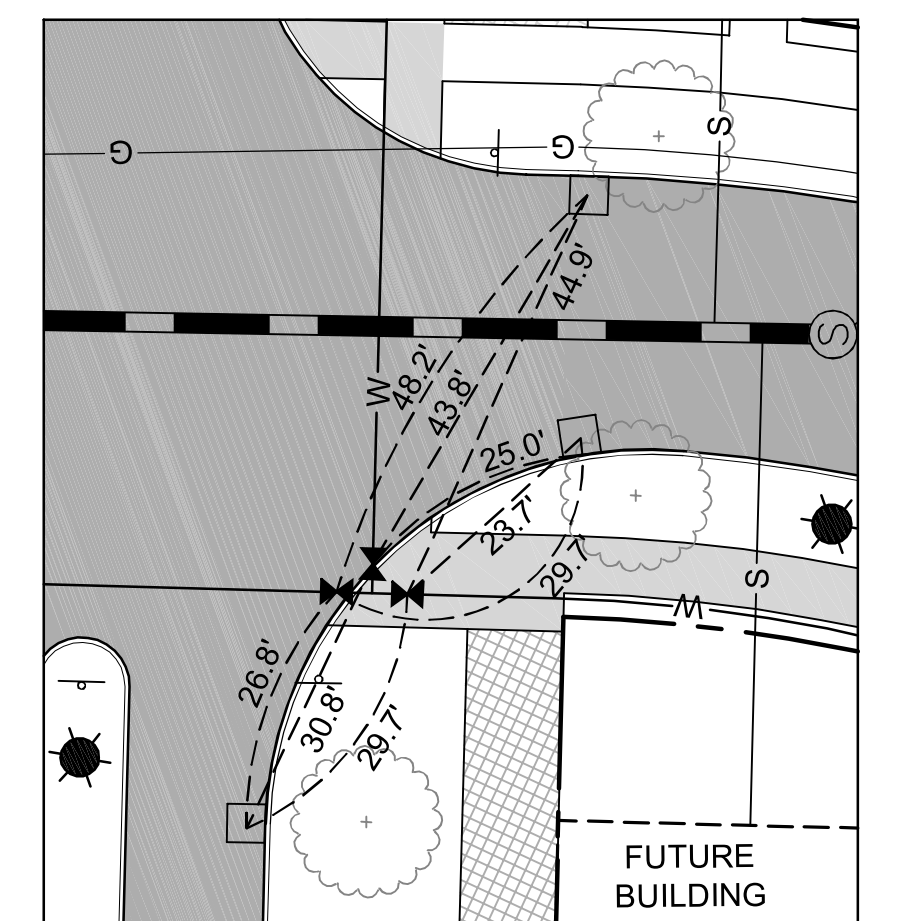

INSET 'B'
SCALE: 1" = 20'

THIS PLAN WAS REVISED IN NOVEMBER 2017 TO SHOW THE RECORD HORIZONTAL LOCATIONS AND TIES TO THE FOLLOWING ITEMS:

- HYDRANTS, VALVES, CURB STOPS

THIS PLAN WAS REVISED IN OCTOBER 2019 TO SHOW THE RECORD HORIZONTAL LOCATIONS OF THE FOLLOWING ITEMS:

- SANITARY MANHOLES, SEWER MAINS & SERVICES
- STORM MAHOLES, CATCH BASINS & STORM PIPES
- WATERMAIN, WATER SERVICES
- GAS MAINS, GAS SERVICES & GAS VALVES
- UNDERGROUND ELECTRIC, CABLE & TELECOMM. CONDUITS
- TRANSFORMER PADS, ELECTRIC PEDESTALS, CABLE PEDESTALS & TELECOMM. PEDESTALS
- LIGHT POLES

THIS PLAN WAS REVISED IN OCTOBER 2019 TO SHOW THE RECORD VERTICAL ELEVATIONS OF THE FOLLOWING ITEMS:

- SANITARY MANHOLE RIMS, SEWER MAIN INVERTS
- STORM MANHOLE RIMS, CATCH BASIN RIMS/GATES, STORM PIPE INVERTS

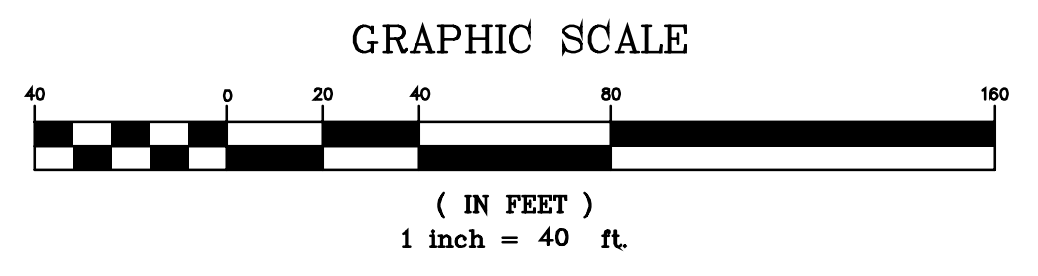

WILLISTON DISCRETIONARY PERMIT DP-09-01
TAX PARCEL # 08:104:010, 08:143:002,004, & 010

REVISIONS		# OF SHEETS
THESE PLANS WITH LATEST REVISIONS SHOULD ONLY BE USED FOR THE PURPOSE SHOWN BELOW:		
	SKETCH/CONCEPT	
	PRELIMINARY	
	FINAL	
	RECORD DRAWING	
FINNEY CROSSING A PLANNED UNIT DEVELOPMENT WILLISTON, VERMONT		proj. no. 01-087
- PLAN - ZEPHYR ROAD		survey L&D
LAMOREUX & DICKINSON Consulting Engineers, Inc. 14 Morse Drive Essex Junction, VT 05452 (802) 878-4450		design DJG/ABR
		drawn L&D
		checked DJG/ABR
		date 11/27/17
		scale AS SHOWN
		sh. no. R3