

**LOCUS**

**LEGEND**

- S As Built Sanitary Sewer
- W As Built Water Main
- ST As Built Storm Sewer

**NOTES**

1. Owner of Record: Village Associates  
75 St Paul Street  
Burlington, VT 05401
2. This plan of As Built locations is produced in increments to allow sales/closings to occur before total completion. Do not use this drawing for construction. See following sheets for detailed locations and ties.
3. Layout (light lines) taken from design plans by Llewellyn-Howley Incorporated and are shown for reference only.
4. As Built locations by Button Professional Land Surveyors, 20 Kimball Ave, South Burlington, VT. Spring 2008.

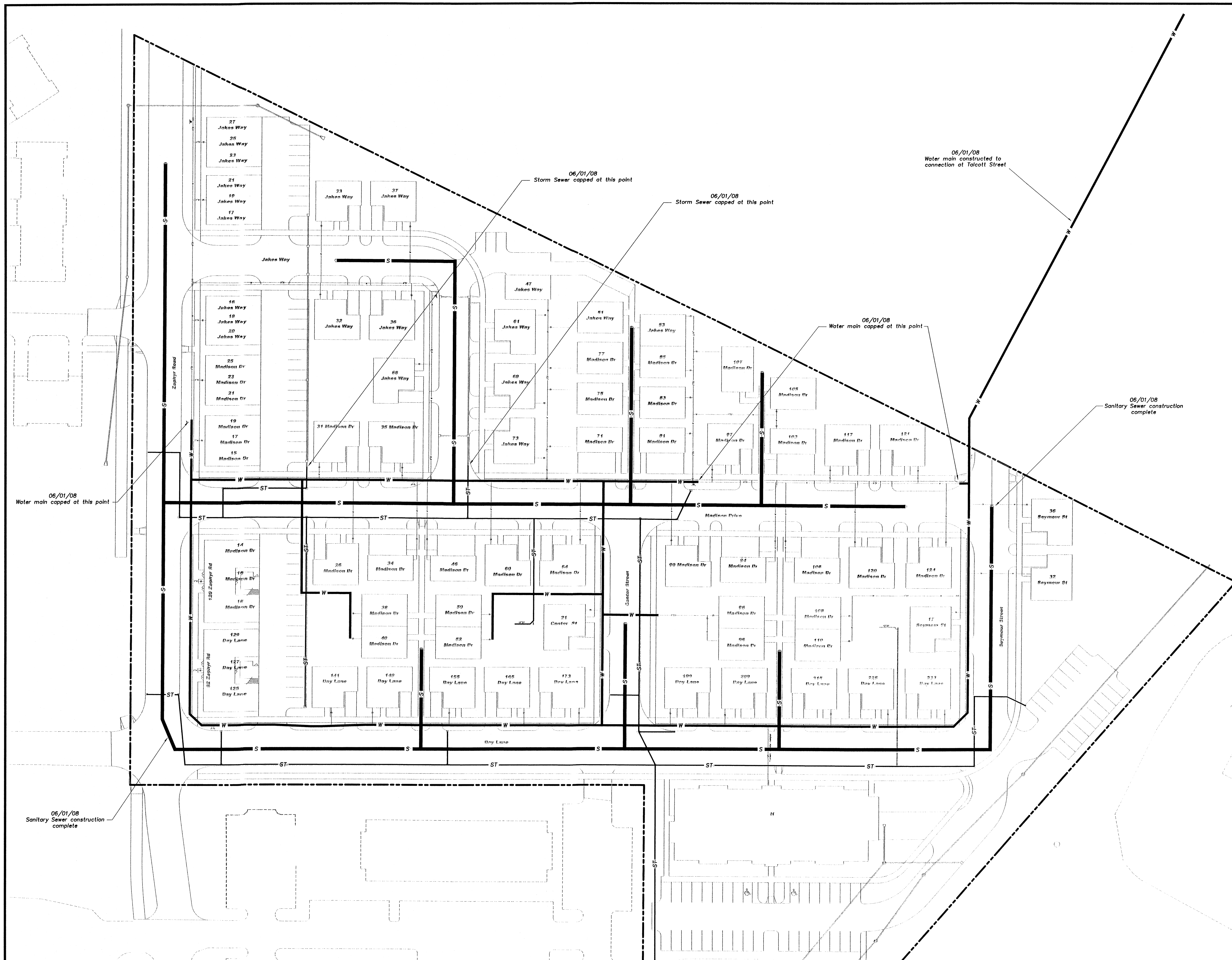
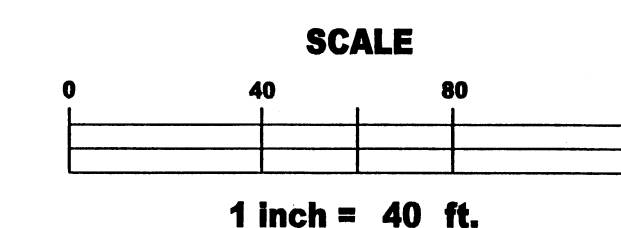
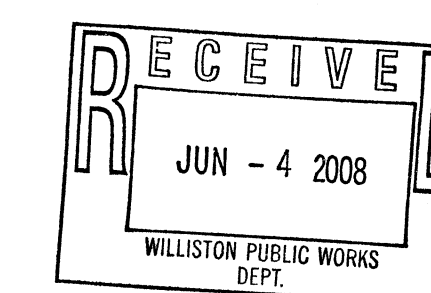

Stage	
Gather Data	June 2008
Submit to Williston	June 2008
Submit to ANR	June 2008
Submit Water Supply	June 2008

No.	Revision	Date

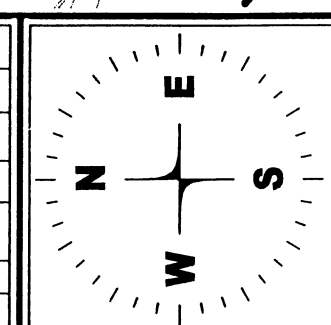

**LLEWELLYN - HOWLEY**  
INCORPORATED  
Consulting Services · Engineering · Permitting  
20 Kimball Ave Ste. 202N F (802) 658-2882  
South Burlington T (802) 658-2100  
Vermont 05403 <http://www.lhinc.net>

Project: 2007024  
Date: 05/20/08  
Drawn by: SLM  
Drawing: 2007024 190  
Sheet: 1 of 5

**THE HAMLET**  
Williston Vermont  
**As Built Overall Site Plan**